

# NEWMARKET PRE-CAST CONCRETE PRODUCTS

Telephone: 905-852-6111 ; Toll Free 1-800-263-1297

## CONCRETE RISER with Aluminum Lockable Hatch

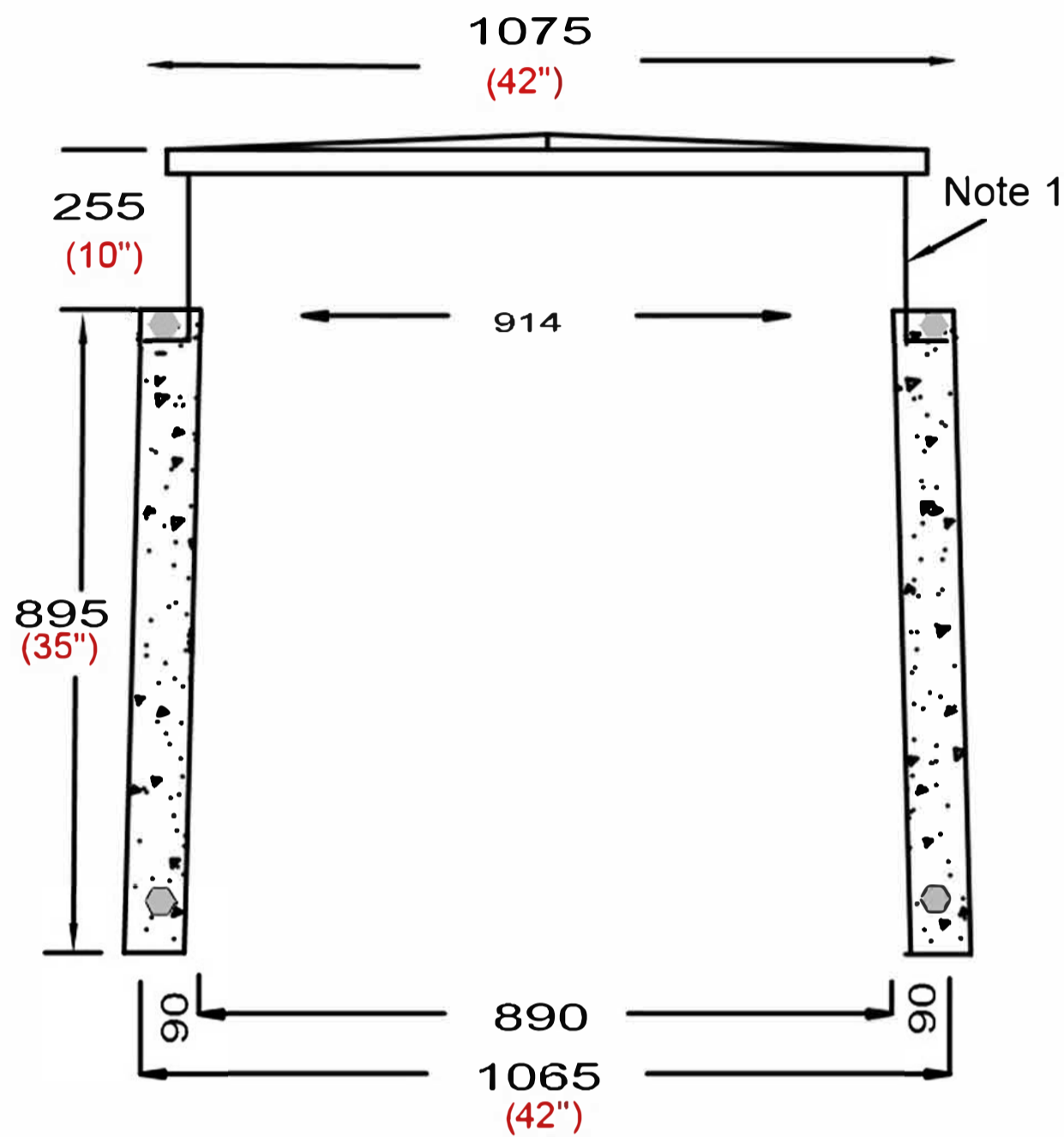

End Elevation Section

Legend  
 ○ 10 m Rebar

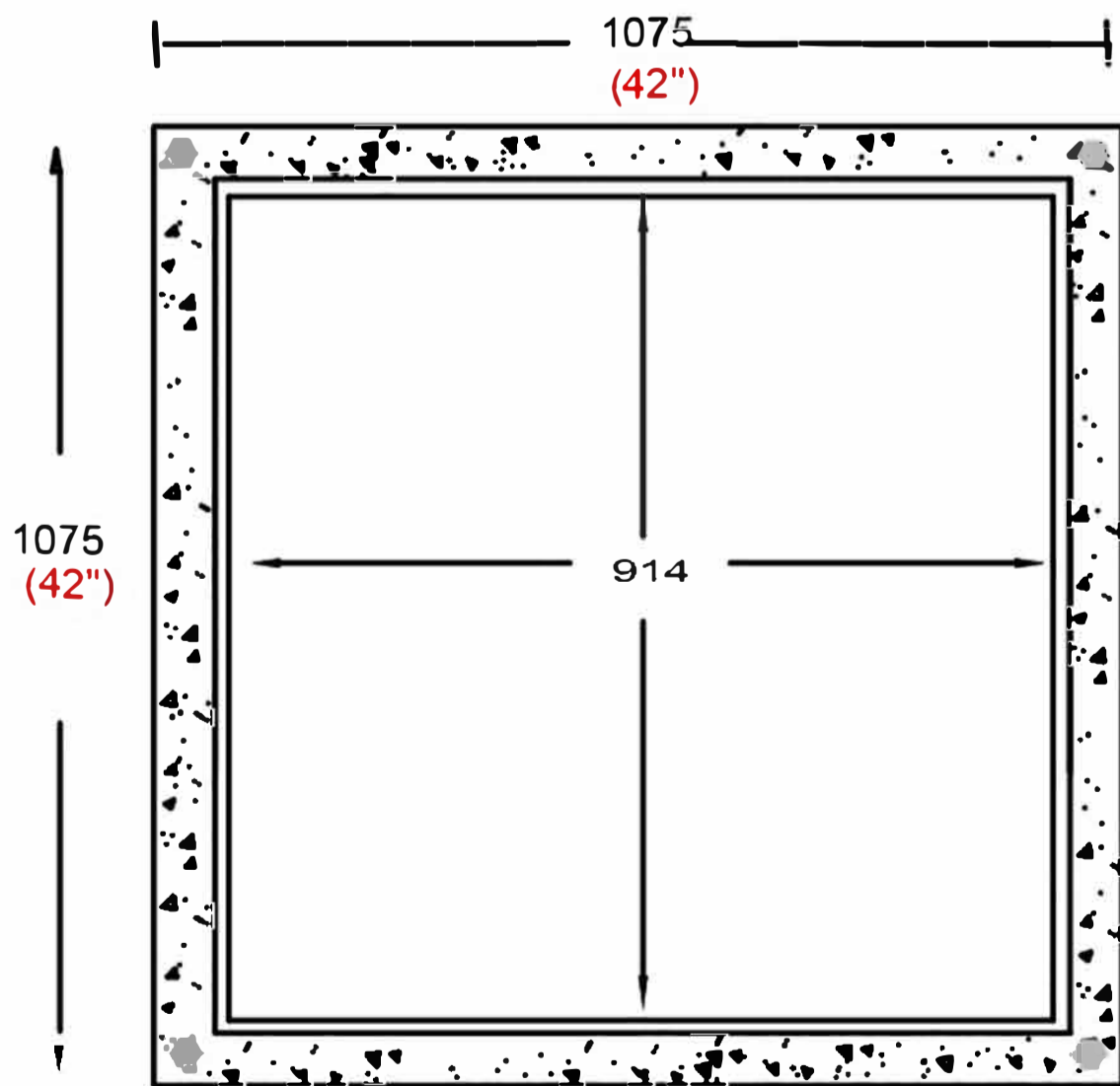

Top Section

- . Design shown is a one piece unit.
- . Cast with 35 MPA strength concrete at 7 days with 5-7% air.
- . Riser reinforcement - floor slab -2- 10m @ 600 E/W
- walls -2- 10m @ 600 horizontal & vertical
- 10m around perimeter with 10m hoop 700mm diameter around riser
- 30mm plastic chairs used to provide concrete cover
- . 50% recommended structural fiber added to concrete .
- . Non sulphate resistant concrete .

Weight. .... 1125 Kg (2480 lb)

Notes: 1. Cast in place 914mm X 914mm aluminum hatch.

