

# NEWMARKET PRE-CAST CONCRETE PRODUCTS LTD.

Telephone: 905-852-6111 ; Toll Free 1-800-263-1297

## Model Low 27,000 (6000 GAL) Holding Tank - 2 Piece Unit Working Capacity 24,996 Litres (5498 Gal)



Top Section

- This tank design is installed in multiple units
  - Each unit is tongue and groove design and is sealed with fibrous mastic sealant
  - tanks are cast with 35 MPA strength concrete at 7 days with 5-7% air
  - Steel reinforced with 20m rebar, spaced at 300mm in each direction at 50mm cover. CAN/CSA-G30.18.
  - Tanks conform to National Standards of Canada CAN/CSA B66-16
  - Non-sulphate resistant concrete
  - Standard (3) 100mm Inlets and 1 outlet fitted with flexible rubber connections
- Top Half Weight.....14,515 Kg (32,000 Lbs)  
Bottom Half Weight.....14,515 Kg (32,000 Lbs)  
Total Tank Weight.....29,030 Kg (64,000 Lbs)

Notes

1. 75mm dia. PVC pipe cast-in to facilitate pump installation or venting
2. Water Storage Capacity to underside of top..... **28,946 Ltrs. (6367 gal.)**
3. Cast in place 610mm ID plastic riser with plastic lid secured with stainless steel fasteners extending 100mm above concrete

Designed for up to two metre burial over top of tank - vehicle traffic tanks are available upon request. Specialty conformations may be possible

To ensure water-tight seal, it is standard practice that the joint be cemented both inside and out

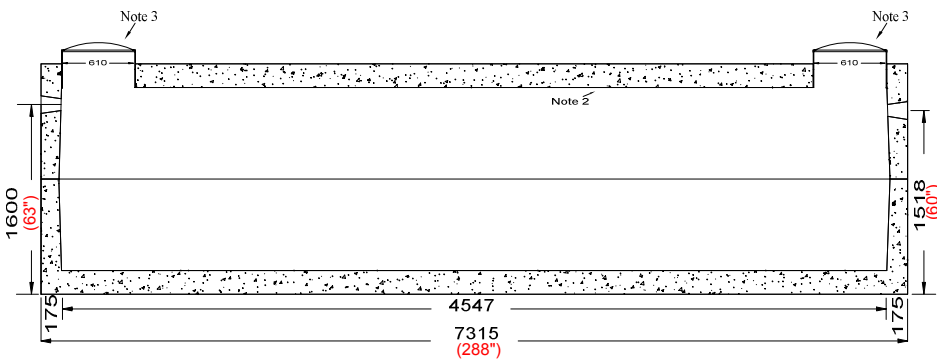

Side Elevation Section

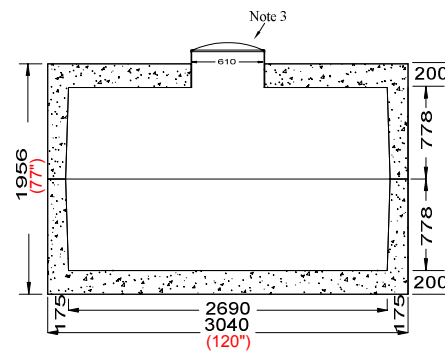

End Elevation Section

Tank Markings Observed:  
Inlet & Outlet is Marked.  
Tank is marked on tank lid - Inlet End

**NPCP**  
2017 HOLDING 27000  
B.D. 2 METRE  
WC 24996  
NON-SULPHATE  
AGINP

