

# NEWMARKET PRE-CAST CONCRETE PRODUCTS LTD.

Telephone: 905-852-6111 ; Toll Free 1-800-263-1297

## Model 68200 (15000 GAL) Holding Tank - 3 Piece Unit Working Capacity 68782 Litres (15130 Gal)

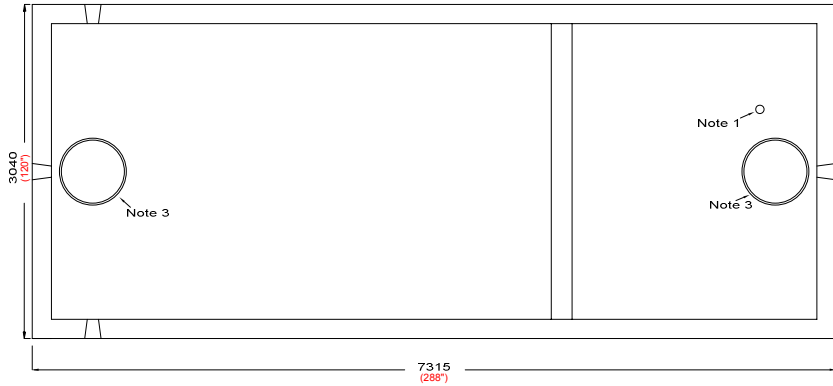

Top Section

- This tank design is installed in multiple units
- Each unit is tongue and groove design and is sealed with fibrous mastic sealant
- tanks are cast with 35 MPA strength concrete at 7 days with 5-7% air
- Steel reinforced with 20m rebar, spaced at 300mm in each direction at 50mm cover. CAN/CSA-G30.18.
- Tanks conform to National Standards of Canada CAN/CSA B66-16
- Non-sulphate resistant concrete
- Standard three 100mm Inlets and one 100mm outlet fitted with flexible rubber connections

Top Third Weight.....	18220 Kg (40,169 Lbs)
Middle Third Weight.....	8754 Kg (19,300 Lbs)
Bottom Third Weight.....	18220 Kg (40,169 Lbs)
Total Tank Weight.....	45195 Kg (99,638 Lbs)

**Notes**

1. 75mm dia. PVC pipe cast-in to facilitate pump installation or venting
2. Water Storage Capacity to underside of top.....**71575 Litres (15,744 Gal)**
3. Cast in place 610mm ID plastic riser with plastic lid secured with stainless steel fasteners extending 100mm above top
4. Monolithically cast in divider for structure.

Designed for up to two metre burial over top of tank - vehicle traffic tanks are available upon request. Specialty conformations may be possible

**To ensure a water-tight seal, seams must be cemented both inside and out**

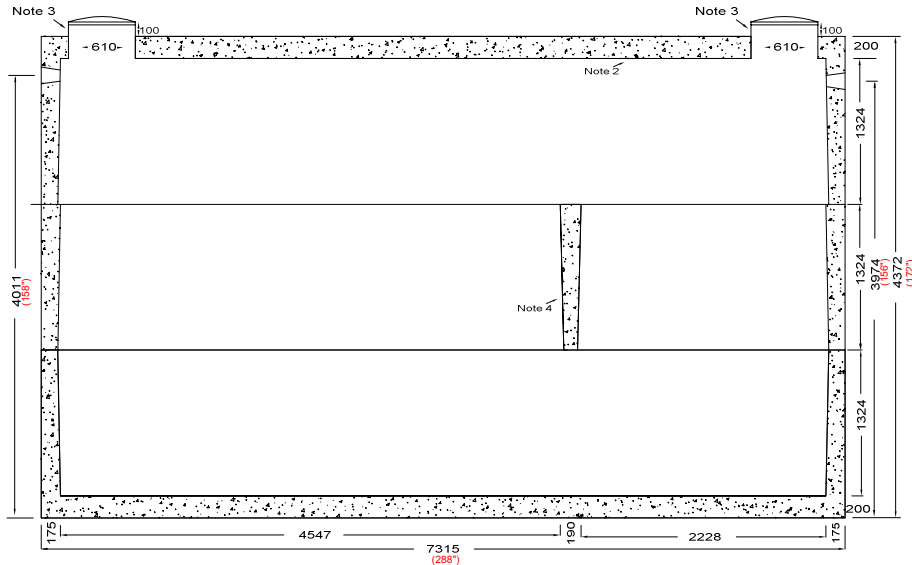

Side Elevation Section

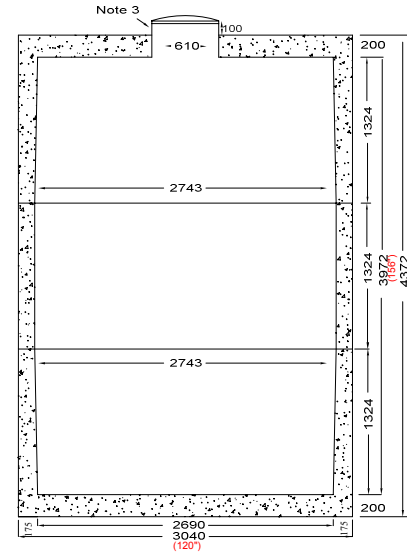

End Elevation Section

Tank Markings Observed:  
Inlet & Outlet is Marked.  
Tank is marked on tank lid - Inlet End

**NPCP**  
2017 HOLDING 68200  
B.D. 2 METRE  
WC 68782  
NON-SULPHATE  
AGINP

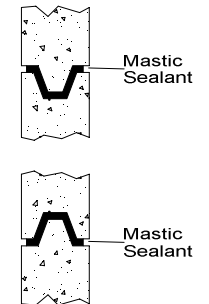

Tongue and Groove Joint